



Rally Awning Instructions



Thank you for purchasing your Kampa awning. Please read these instructions carefully before attempting to set up your awning and retain for future reference. If used properly, your awning should give you years of trouble free use. We recommend that your awning is insured against accidental and storm damage as this is not covered by the warranty. Awnings contain a high proportion of synthetic materials and under certain conditions will be affected by condensation inside the awning. This should not be confused with leaking and condensation can be improved by ensuring adequate ventilation.

We recommend a trial run before using your awning for the first time. This will allow you to familiarise yourself with the awning, its set up and any limitations the awning may have for your particular use. Please also check your caravan awning rail to ensure that it is not damaged or has any sharp edges that could damage your awning.

PARTS LIST

Awning flysheet	1
Dynaflex roof poles (Rally 260 only)	3
Dynaflex roof poles (Rally 390 only)	4
Dynasteel leg poles with adjustable feet (Rally 260 only)	3
Dynasteel leg poles with adjustable feet (Rally 360 only)	4
Dynalite aluminium adjustable roof stretcher poles	2
Peg bag	1
Draught skirt	1
Carry bag	1

If any parts are missing please contact your supplying retailer immediately.

SITING

Choose a site that is flat and, if possible, protected from the wind. Try to set up your awning with the doors facing away from the wind.

SET UP

To protect your awning from dirt and damage, it may be beneficial to lay a groundsheet or awning carpet down before unpacking.

Unpack the awning, separate and identify the different parts.

Assemble the flexible roof poles, these are shock corded together and just need slotting together, ensuring that each pole is fully inserted into the adjoining metal ferrule.

Assemble the steel legs. They are spring linked and just need slotting together. They have an adjustable foot. ensure that this is in its lowest position (making pole shorter) by using the spring button adjustment. Slide the awning beading, on the rear of the awning roof, through the caravan awning channel until it is in your required position. The awning should be positioned on a horizontal part of the caravan.



Starting at one end of the awning, push a flexible roof pole into the pole sleeve, connect the steel pole to the end and then locate the bottom of this pole onto the pin at the bottom of the awning. The pin is on an adjustable webbing strap. The strap can be released to make it easier to insert the pin into the bottom of the pole. Always retighten the straps to ensure that the awning is tensioned correctly. Clip the plastic clips onto the steel pole. Continue with the other poles. It may make assembly easier if you loosely guy out the two end poles as you progress.

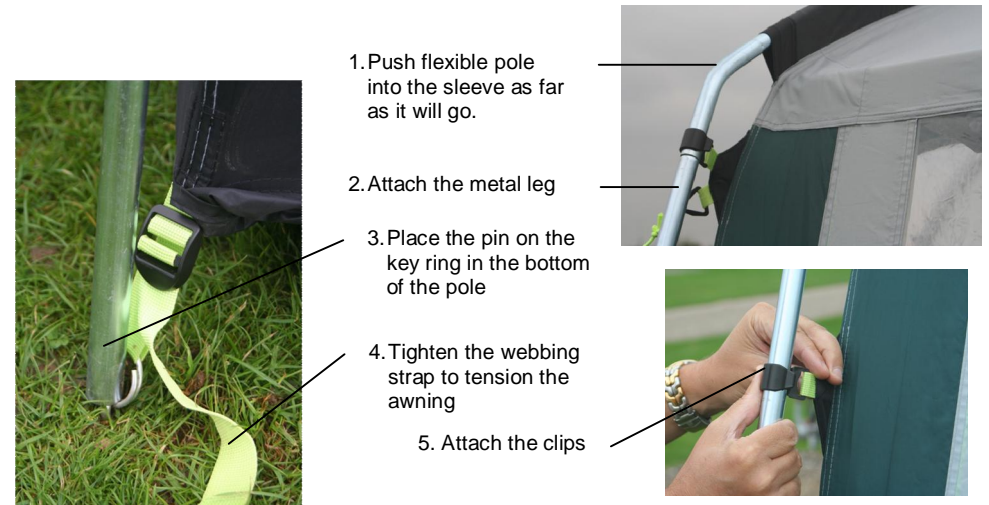

Once you have assembled all the legs, go inside the awning and insert the two horizontal aluminium stretcher poles. Insert one end of the first pole into the retaining pocket at one end of the awning and then insert the other end in the corresponding pocket at the other end. Tension the pole and tighten the thumbscrew. Repeat with the other pole. The stretcher poles should now be secured to the awning using the tie tapes sewn into the roof.



Install the two horizontal aluminium stretcher poles. There is one just above the windows and another half way up the roof.

Close all doors and entrances. Peg the rear corners of the awning. The awning wall should be vertical and the pegging point should be pulled slightly under the caravan to ensure a good seal between awning and caravan. The pegging points have a range of possible pegging options. Select a point that puts the awning under tension but without over stressing.

Once the rear corners have been pegged, peg each front corner. It is necessary to pull each pegging point diagonally to create tension in the awning. It may also be necessary to adjust the length of the leg.

Peg the intermediate pegging points, pegging the points either side of doorways first. These doorways should be cross pegged. The points should be pulled across each other. Once completed the awning should look taut without too many creases. If necessary readjust the pegging and adjust the height of the legs.

PEGS

The Rally awning comes complete with general purpose wire pegs. These will be suitable for many sites but there will be some instances where different pegs will be necessary. Your dealer will stock a range of pegs suitable for different types of ground. For maximum effectiveness, pegs should be driven into the ground at a 45° angle away from the pegging point.

GUY ROPES

The Rally comes with guylines pre-attached. We recommend that these guylines are used at all times. Peg the guylines so that the awning is under tension without distorting the shape. The guylines can be adjusted using the runners. Guylines should be secured using suitable pegs. See above.

SEALING BUMPER PADS

To help create a seal between caravan and awning the Rally has sealing bumper pads sewn to the rear panels. Using the rear pegging points, these bumpers should be pulled towards the caravan. An improved seal can be maintained by use of the optional rear upright pole set. Insert the top of each pole into the pocket in the top rear corner, adjust the height to bring the pole under tension and then secure the to the bumper pads using the tie tapes.



DRAUGHT SKIRT

The supplied draught skirt should be slid through the awning rail at the bottom of your caravan.



SEAMS

The main seams of this awning have been factory taped to help prevent leakage. Depending upon your expectations, it may be necessary to treat the remaining seams with a seam sealant. Seam sealant should also be applied to areas where the taping is damaged or has peeled away through wear and tear. It can also be applied to areas where a leak may have developed. Seam sealant is available through your dealer. We recommend McNett Seamsure.

SUITABILITY

This awning is designed for use in light to moderate weather. During strong winds or snowfall we recommend that you take your awning down. The awning is designed for occasional use; it is not designed for static or commercial use.

UV DEGRADATION

Awning fabrics can be weakened by prolonged exposure to sunlight. Under normal holiday use your awning will give long service but use for extended periods in strong sunlight will soon cause deterioration. In those cases it would be wise to use a site as shaded as possible. UV degradation is not covered under the warranty. The warranty does not cover awnings used on permanent sites, displays or for commercial purposes.

CONDENSATION

Awnings contain a high proportion of synthetic materials and under certain conditions will be affected by condensation inside the awning. This should not be confused with leaking and condensation can be improved by ensuring adequate ventilation. Condensation and its effects are not covered under the warranty.

SAFETY

DO NOT COOK IN THE AWNING OR USE NAKED FLAMES. READ AND UNDERSTAND THE FIRE PRECAUTIONS LABEL SEWN INTO THE INSIDE OF THE AWNING.

DISMANTLING

Reverse the set up procedure. Ensure that all parts are clean before packing in the carry bag. If the awning is wet or damp, dry fully as soon as possible.

CARE

Awnings are best stored opened out. Air fully and ensure it is totally dry before packing away. Store in a well ventilated dry place. A wet/damp awning will develop mildew surprisingly quickly. Dirty awnings can be washed using clean water and a soft brush. Do not scrub and never use detergents.

Poles should be protected from damage and should be stored completely dry to prevent corrosion of the ferrules. To prevent corrosion Dynasteel poles can be stored with a light coating of petroleum jelly to protect them. Ensure that this is completely removed before use. Damage due to improper use, wind damage or neglect is not covered under the warranty. Have any damage repaired at the first opportunity. Failure in the poles normally occurs through incorrect use. Make sure that poles sections are fully inserted into their adjoining pole and do not over stress the pole beyond its designed curve. You can purchase replacement poles from your dealer.

Zips should be treated with care, use two hands to close and open and never tread on them. Never force a zip.

We strongly recommend that you carry a comprehensive spares kit including silicone waterproof spray, seam sealer, tape for repairing split poles, and spare guy ropes and pegs for extreme weather.

Repairs to the flysheet should be made by a company recommended by Kampa or your supplying

Kampa UK Limited
Witham
CM8 3NF

